

Main facts at a glance



Technical data

System width	Capacity	Conveyor speed
350 mm	20.000 eggs/h	7 m/min (23 ft/min)
500 mm	30.000 eggs/h	7 m/min (23 ft/min)

Drives	Power of gearmotor	Voltage
Front drive Intermediate drive Mini drive	0,37 kW or 0,18 kW	230/400 V 50 Hz other voltage on demand

Measurement

Conveyor section

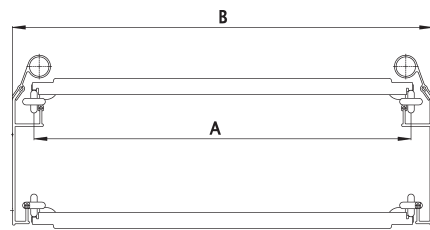

Conveyor width [mm]

Typ 350	Typ 500	Index
350	500	A
390	540	B
750	1080	R i
945	1350	R m
1140	1620	R a

Radius of bend

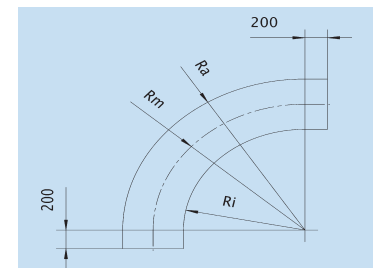

Ascend and descend up to max. 60°:

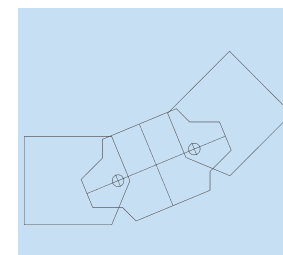
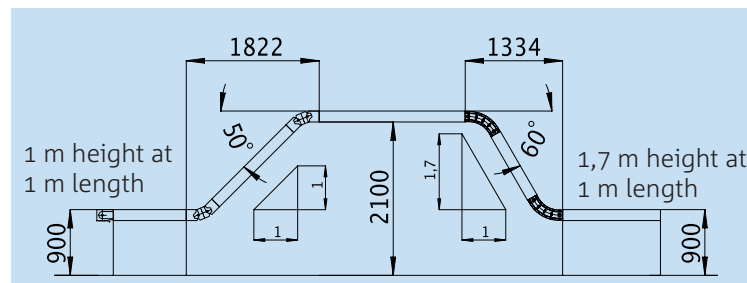

Pivoting unit adjustable up to 50°

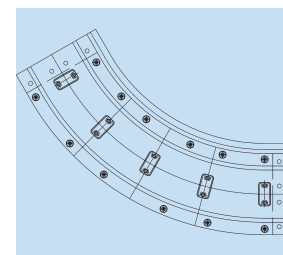

Slope segments 60° (possible with cover caps only)

For further information: www.lubing.com

Technical modifications reserved.

Steep conveyor “Climber” for the eggtransport up to 60°

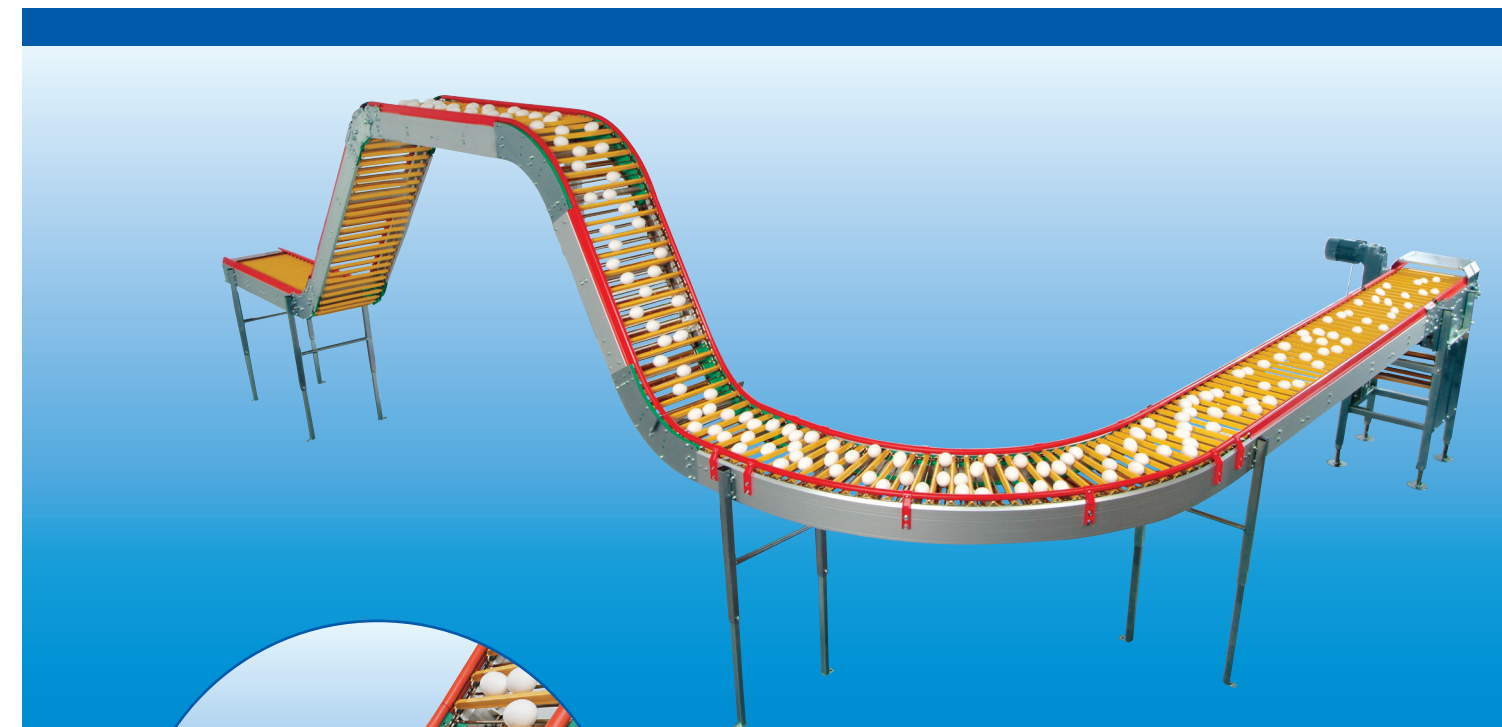

LUBING



Drinking-Systems
Conveyor-Systems
Climate-Systems

LUBING Maschinenfabrik GmbH & Co. KG

Lubingstraße 6 · 49406 Barnstorf (Germany)
Tel.: +49 (0) 54 42 - 98 79-0 · Fax: +49 (0) 54 42 - 98 79-33
www.lubing.com · info@lubing.com

0882-1 / 10-12 / 500

The LUBING Steep conveyor “Climber” for egg transport with extreme inclines

The principle

The LUBING Steep conveyor “Climber” works with two outer guided round-link chains with welded cross bars. This guarantees high performance of function.

Together with the plastic tab elements it is the key point of the conveyor and allows to have inclines or declines up to 60° (possible with cover caps only).

In the center of the conveyor no supports or guide elements are needed for dividing or diverting the egg flow.

The basic elements

All parts are according to the LUBING curve conveyor system but especially designed for farms with floor management as breeder egg farms as well as conveyors for dirty egg return a.s.o.

The system consists of proven standard parts as drives, bends, pivots, telescopes for lift systems and intermediate drives for long conveyors without transfers are parts of this concept.

Steep inclines or declines are accomplished on short distances.

Trouble free level changes of 67 inch (1,7 m) height by 39,5 inch (1 m) length are possible.

Custom plans available to suit individual requirements.

Pivoting unit

Adjustable revolving pivoting units to alter up to 50° up wards.

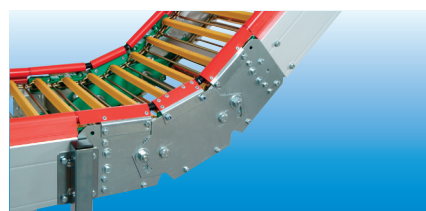

Pivoting unit

Adjustable revolving pivoting units to alter up to 50° down wards.



Slope segment

Slope segments fixed for descends of 60° (possible with cover caps only).



Slope segment

Slope segments fixed for ascends of 60° (possible with cover caps only).

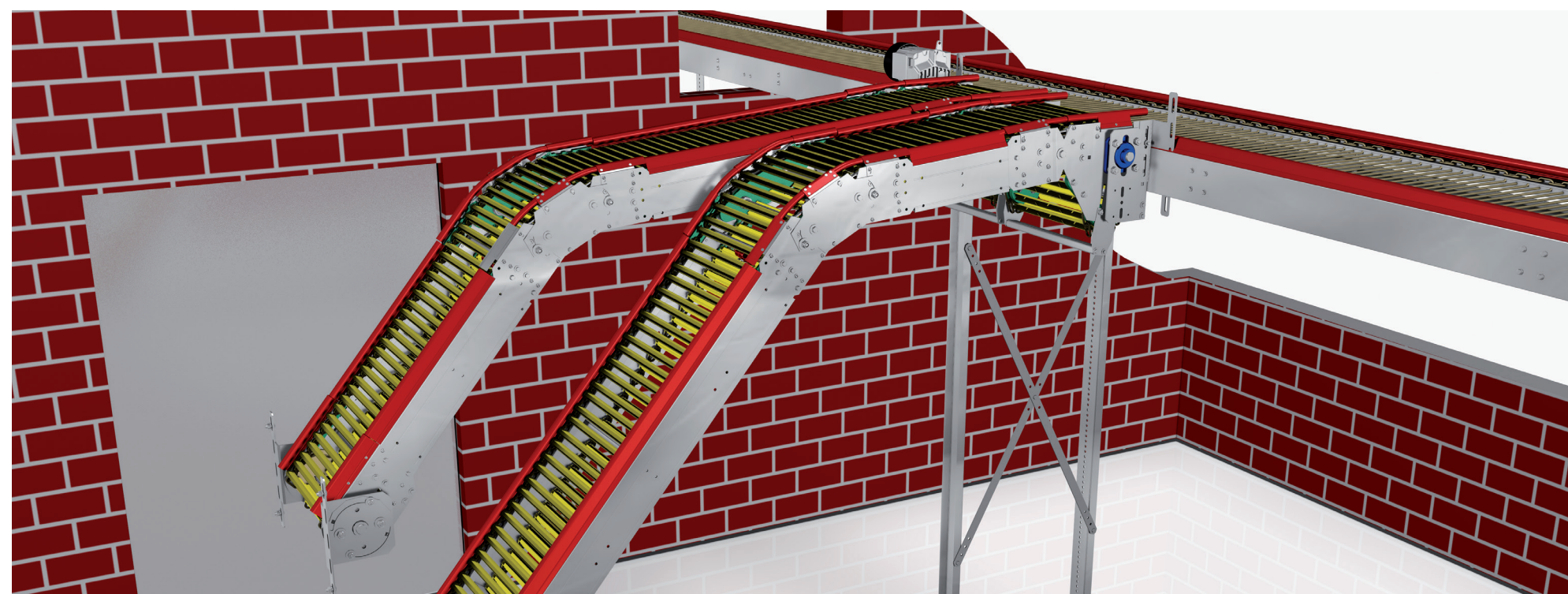

Egg flow at ascend

No center supports disturb the egg flow due to outer guided round-link chains.

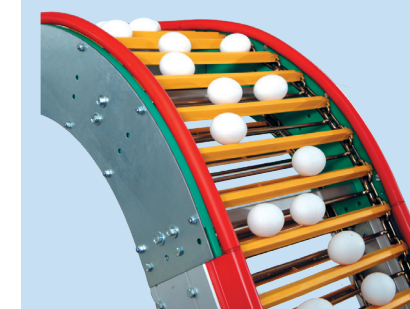

Egg flow at descend

The tab element keeps the eggs in stable position at descends or ascends of the conveyor.



Trampoline Transfer

With a special net that takes the eggs springy and transports them softly into the conveyor chain.



End units

Simple and safe idling units located at the end of the conveyor line by using idling pulleys.



Bends

Bends are available with angels from 5° up to 180°.

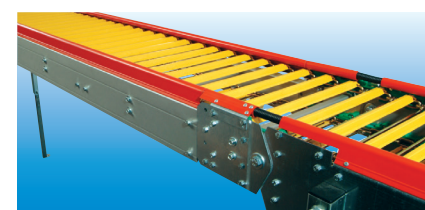

Connecting parts

Connecting parts are available in 2 meter (78,5 inch) and 3 meter (118 inch) lengths.



Front drives

The conveyor is driven by the driving sprockets of the front drive. A chain tensioner is integrated for the right tension of the chain.



Conveying at the bend

At the inner radius of the bends the eggs are lifted carefully by the tab elements of the conveyor chain.